



SECURITY LED BCL200

2 1/2" DEEP WET LOCATION SECURITY CANOPY LUMINAIRE

JOB	
TYPE	
DATE	

WWW.LALIGHTING.COM

TEL: 626-454-8300

SURFACE/SUSPENDED MOUNTED LED LUMINAIRE

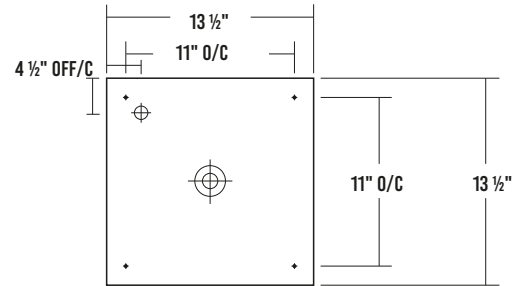
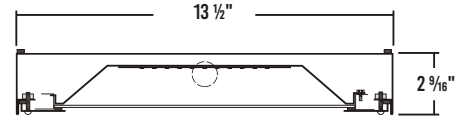

⊕ 2" K.O.
⊕ 7/8" K.O. on side of housing

SPECIFICATIONS

CONSTRUCTION

- 20 gauge electro-galvanized steel construction
- Neoprene gasket back housing
- Aluminum heat sink cover
- Stainless steel fasteners
- Two side knockouts for 1/2" conduit (knockouts on opposite sides of fixture)

FINISH

- Baked white powder-coated finish
- Minimum reflectance 90%
- Painted after fabrication

OPTICAL

- Clear Prismatic Polycarbonate, Nom. 0.125"

ELECTRICAL

- High-efficiency drivers coupled with long-life LEDs
- Service life tested at 50,000 hours (L70)
- Universal voltage 120V through 277V (347V / 480V available)
- Power Factor (PF) ≥ 0.9
- Total Harmonic Distortion (THD) ≤ 20%

LISTING

- UL USA and Canada listed / suitable for damp locations

WARRANTY

- 5-Year limited warranty standard. 10-Year limited warranty also available

APPLICATIONS

- Canopies, Covered Outdoor Areas, Stairwells, Pedestrian Tunnels

FEATURES

- 0-10V Dimming driver standard
- Wet Location (UL Listed with sprinkler test)
- Supports California Title 24 compliance

OPTIONS CONTACT CUSTOMER SERVICE FOR ADDITIONAL OPTIONS

- Controls
- Custom housing colors
- Tamper proof screws
- Pendant mounting adapter
- Emergency battery pack
- Customization available upon request

CUSTOM COLORS

BLK - Matte Black

CS - Camaro Silver

BZ - Statuary Bronze

Variety of RAL colors available upon request.



Los Angeles Lighting Mfg. Co.

Contact Us

T: 626-454-8300
F: 626-454-8399
www.lalighting.com

10141 Olney Street
El Monte, CA 91731
Made in the USA



Due to continued product improvements and enhancements, Los Angeles Lighting Manufacturing Company reserves the right to alter specifications, dimensions, data, and/or materials without notice. Please visit our website to view the most current information.

© 2023 LOS ANGELES LIGHTING MANUFACTURING CO. ALL RIGHTS RESERVED.

Revised: 04/11/2023



MADE IN THE USA
BAA Compliant

ORDERING INFORMATION

ADDITIONAL OPTIONS AVAILABLE. VISIT WWW.LALIGHTING.COM/RESOURCES FOR MORE INFORMATION

EXAMPLE: BCL200-4-1L-PPC2-DRDM-UNV-1/840

SERIES	NOMINAL LED LUMENS	NOMINAL LENGTH	COLOR	OPTICAL	MECHANICAL	CONTROLS	ELECTRICAL	DRIVER	VOLTAGE	# OF LED ROW	CRI / CCT
BCL200		1L		PPC2						1	
BCL200 • 2½" Deep Wet Location Security Canopy <i>Contact customer service for additional lumen packages</i>	2 - 2000lm 3 - 3000lm 4 - 4000lm	1L • 1' x 1'	(Blank) • Standard White BLK • Matte Black BZ • Statuary Bronze CS • Camaro Silver *Consult factory for available RAL options	PPC2 • Clear Prismatic Polycarbonate, Nom. 0.125"	TP • Tamper Proof Screws • Hex Socket w/Post Leave blank if not specified	MSH • High Frequency Microwave Motion Sensor (Mounted Behind Lens) MSHSD • Step Dimming High Frequency Microwave Motion Sensor (Mounted Behind Lens) PCS • Photocell WLC(LED RU) • Wireless Control Leave blank if not specified	BPL1.5 • Emergency Battery Pack • 1500 lm Leave blank if not specified	DRDM • 0-10V Dimming Driver *Contact factory for additional driver options	UNV • 120V-277V 120V • 120 Volt 277V • 277 Volt 347V • 347 Volt 480V • 480 Volt *Contact factory for additional voltage options	1 One LED Row	830 • 80+CRI / 3000K 835 • 80+CRI / 3500K 840 • 80+CRI / 4000K 850 • 80+CRI / 5000K <i>Contact customer service for additional CRI/ CCT packages, including 90CRI</i>

SYSTEM DATA

ADDITIONAL LUMEN PACKAGES AVAILABLE. CONTACT CUSTOMER SERVICE FOR MORE INFORMATION

NOMINAL LED LUMEN PACKAGE	NORMAL AMBIENT TEMPERATURE PRODUCT CODE	DELIVERED LUMENS	SYSTEM WATTS	LUMINAIRE EFFICACY	AMBIENT TEMP.	CFL EQUIVALENT	IES FILES
2000 Lumens (Nominal)	BCL200-2-1L-DRDM-UNV- 1/840	1822 lm	17.1	106.3 lm/W	-20°C / 35°C	2-13WCFL G24Q-1	LA-T3602b
3000 Lumens (Nominal)	BCL200-3-1L-DRDM-UNV-1/840	2630 lm	24.7	106.5 lm/W	-20°C / 35°C	2-26WCFL G24Q-3	*
4000 Lumens (Nominal)	BCL200-4-1L-DRDM-UNV-1/840	3413 lm	32.0	106.83 lm/W	-20°C / 35°C	2-32WCFL GXG24Q-3	LA-T3389b

NOTE:
 System data is based on 120V input voltage. Actual performance may differ as a result of end-user environment and application.
 This fixture has been tested and listed in accordance with UL Standards. L.A. Lighting certifies that it will operate safely when installed properly, and within an ambient temperature range noted in the system data table.
 Additional lumen packages and color temperatures available.



Los Angeles Lighting Mfg. Co.
 Contact Us
 T: 626-454-8300
 F: 626-454-8399
 www.lalighting.com
 10141 Olney Street
 El Monte, CA 91731
 Made in the USA



Due to continued product improvements and enhancements, Los Angeles Lighting Manufacturing Company reserves the right to alter specifications, dimensions, data, and/or materials without notice. Please visit our website to view the most current information.
 © 2023 LOS ANGELES LIGHTING MANUFACTURING CO. ALL RIGHTS RESERVED.

Revised: 04/11/2023



TAMPER PROOF SCREWS

TP

- Hex Pin Stainless Steel Tamper Proof Screws



CONTROL OPTIONS



enocean®

WLC(LED RU) - EnOcean LED Relay Zone Controller

- Supports a single LED fixture or multiple daisy chained LED fixtures
- Module installed inside lighting fixture

ESRPU-W-EO - EnOcean Rocker Switch – Single – Surface Mount

- Wireless single rocker switch with mounting plate
- No batteries needed

EDRPU-W-EO - EnOcean Rocker Switch – Double – Surface Mount

- Wireless double rocker switch with mounting plate
- No batteries needed

S3054-N300 - EnOcean Navigan NWC 300U – Commissioning Tool

- Navigan Wireless Commissioner is used to configure EnOcean controllers & sensors
- It can be used to define link tables, change parameters/settings, & to edit & store projects
- Configuration settings can be saved & cloned to enable quick configuration
- Connectivity is through the NWC 300U USB Stick

EOSWU-W-EO - EnOcean Occupancy Sensor – Wall Mount

- Wireless wall mounted occupancy sensor
- Solar powered - no batteries needed (coin battery operated in low light conditions)
- PIR motion sensor with both wide angle (50ft) and long range (100ft) options
- Mounting height: 6-8ft

EOSCU-W-EO - EnOcean Occupancy Sensor – Ceiling Mount

- Wireless ceiling mounted occupancy sensor
- Solar powered - no batteries needed (coin battery operated in low light conditions)
- PIR motion sensor with 360° viewing angle lens (34' diameter)
- Mounting height: 7-10ft

ELLSU-W-EO - EnOcean Light Level Sensor – Ceiling Mount

- Light Level sensor that measures and reports the level of available natural light
- Solar powered - no batteries needed (coin battery operated in low light conditions)
- Enables implementation of daylight harvesting control systems
- Mounting position: At the ceiling, close to ambient light source



Los Angeles Lighting Mfg. Co.

Contact Us
 T: 626-454-8300
 F: 626-454-8399
 www.lalighting.com

10141 Olney Street
 El Monte, CA 91731
 Made in the USA



Due to continued product improvements and enhancements, Los Angeles Lighting Manufacturing Company reserves the right to alter specifications, dimensions, data, and/or materials without notice. Please visit our website to view the most current information.

© 2023 LOS ANGELES LIGHTING MANUFACTURING CO. ALL RIGHTS RESERVED.

Revised: 04/11/2023



CONTROL OPTIONS

MS(W)(Lens Option) - Motion Sensor¹
 • Turns light ON/OFF with motion detection

MSSD(W)(Lens Option) - Motion Sensor – Step Dimming (Bi-Level)¹
 • Step-dims output with motion detection

MSPC(W)(Lens Option) - Motion Sensor & Photocell¹
 • Holds lights OFF when sufficient daylight is present regardless of motion detection

MSPCD(W)(ADC)(Lens Option) - Motion Sensor & Photocell Dimming (Auto Dim Control)¹
 • Automatically dims output through preset photocell
 • ON/OFF with motion detection

MSPCD(W)(ANL)(Lens Option) - Motion Sensor & Photocell Dimming (Auto Night Light)¹
 • Automatically dims output through preset photocell
 • Low setting when unoccupied full ON with motion
 • For 24 hour use

MSPCDBT(W)(Lens Option) - Motion Sensor & Photocell Dimming (Setup w/Smartphone App)²
 • Field adjustable dimming sensor capabilities:
 » Step-dims (HIGH/LOW output)
 » Auto Dim Control (dim to desired foot-candles, ON/OFF with motion)
 » Auto Night Light (dim to desired foot-candles, LOW without motion)
 • Holds lights OFF when sufficient daylight is present regardless of motion detection
 • Adjustable ramp up & fade down time
 • Remote setup & adjustment via the iOS® or Android® sensor configuration app

MSPCDR(W)(Lens Option) - Motion Sensor & Photocell Dimming (setup w/Remote Control)²
 • Field adjustable dimming sensor capabilities:
 » Step-dims (HIGH/LOW output)
 » Auto Dim Control (dim to desired foot-candles, ON/OFF with motion)
 » Auto Night Light (dim to desired foot-candles, LOW without motion)
 • Holds lights OFF when sufficient daylight is present regardless of motion detection
 • Adjustable ramp up & fade down time
 • Remote setup & adjustment via handheld wireless tool sold separately
 P/N: REMOTE(Mfg. Name)

Mounting Heights
¹ - 8-45ft
² - 8-40ft

MS E W (LW)

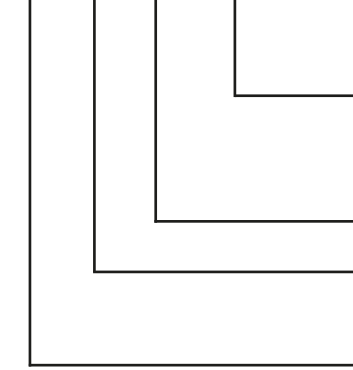

LENS OPTION		COVERAGE
(LW)	Extra Wide	6x Height
(H)	High Bay	3x Height
(L)	Standard	2x Height
(A)	Aisle Way	3x Height
(Blank)	No Specified Lens Option	

Lens Options

**Not all sensor configurations allow for alternative lens configuration. Please consult factory for additional information.*

(Blank) - Leave blank for damp listed
W - Wet Listed

(Blank) - Leave blank for default mounting position
E - End mounted sensor location

MS - Turns light ON/OFF based on motion detection
MSPC - Holds light OFF when sufficient daylight is present regardless of motion
MSSD - Step-dims output with motion detection
MSPCD - Automatically dims output through preset photocell, ON/OFF with motion detection
PCS - Photocell
PCSD - Photocell with step-dimming

**Not all sensor configurations allow for apply to all fixtures. Please consult factory for additional information.*

HIGH FREQUENCY MOTION SENSORS

MSH - Motion Sensor High Frequency (Microwave)
 • Super high frequency motion sensor (also known as microwave sensor) which detects movement when installed behind low density fixture materials, such as polycarbonate, acrylic and glass diffusers
 • Turns light ON/OFF based on motion detection
 • Fixture mounting height ~30ft

MSHSD - Motion Sensor High Frequency Step Dimming (Microwave)
 • Step-dims output with motion detection
 • Turns light ON/OFF based on motion detection
 • Fixture mounting height ~30ft



Los Angeles Lighting Mfg. Co.
 Contact Us
 T: 626-454-8300
 F: 626-454-8399
 www.lalighting.com
 10141 Olney Street
 El Monte, CA 91731
 Made in the USA



Due to continued product improvements and enhancements, Los Angeles Lighting Manufacturing Company reserves the right to alter specifications, dimensions, data, and/or materials without notice. Please visit our website to view the most current information.

© 2023 LOS ANGELES LIGHTING MANUFACTURING CO. ALL RIGHTS RESERVED.

Revised: 04/11/2023



DRIVER OPTIONS

BATTERY PACK OPTIONS

DRDM () () UNV

VOLTAGE

- UNV** Universal 120-277V (For DR2W Driver Type) **Standard Stock Item*
- 120V** 120 Volt (For DR2W Driver Type)
- 277V** 277 Volt (For DR2W Driver Type)
- 347V** 347 Volt
- 480V** 480 Volt

SPECIFIC DRIVER

- XXX** Manufacturer's Name/Part Number
- Blank** Not Specified

WARRANTY

- Blank** 5-Year Limited Warranty - Standard
- TY** 10-Year Limited Warranty

DRIVER TYPE

- DRDM** 0-10V Dimming Driver **Standard Stock Item*
- DRDM1** 0-10V Dimming Driver, 1% Dimming
- DRDM2C** 2-Channel 0-10V Dimming Driver (for Color Tunable White)
- DR2W** 2-Wire Phase Dimming Driver (TRIAC, Mark 10) Please Specify Voltage in Voltage Field
- DRDA** Digital Addressable DALI Dimming Driver
- DRDA2C** Digital Addressable DALI Type 8, 2-Channel Driver (for Color Tunable White)
- DRSD** Step Dimming Driver
- DR(LTEA2W)** Lutron® 2-Wire, 1% Dimming Driver (120V Forward Phase only)
- DR(LDE1)** Lutron® EcoSystem 1% Soft-On, Fade-to-Black
- DR(PEQ0E)** Lutron® EcoSystem 0.1% Soft-On, Fade-to-Black Dimming Driver
- DR(PSQ020)** Lutron® T-Series Digital 1% Dimming 2-Channel Driver (for Color Tunable White)
- DRCR(DXL)** Osram Dexal Driver
- DRCR(SR)** Signify Sensor Ready Driver
- DRCR(XXX)** Control Ready Driver (Specify Driver Manufacturer)

BATTERY PACK OPTIONS

LED EMERGENCY BATTERY PACKS

Minimum 90-minute operation unless otherwise noted

BPL 1.5 (2H)

OTHER SPECIFICATION (Manufacturer, Run Time, etc.)

2H 2 Hours

LUMEN PACKAGE

- 0.7** Nominal 750 Lumens
- 1.5** Nominal 1500 Lumens **Standard Stock Item*
- 3.0** Nominal 3000 Lumens
- 4.0** Nominal 4000 Lumens
(Additional lumen packages available)

TYPE

- (Blank)** Normal Ambient Temp. / Standard Operation
- C** Cold Environment (-20°C)
- F** Flex Cable for Remote Mounting
- SL** Slim Casing
- ST** Self Test / Diagnostic



Los Angeles Lighting Mfg. Co.
 Contact Us
 T: 626-454-8300 10141 Olney Street
 F: 626-454-8399 El Monte, CA 91731
 www.lalighting.com Made in the USA



Due to continued product improvements and enhancements, Los Angeles Lighting Manufacturing Company reserves the right to alter specifications, dimensions, data, and/or materials without notice. Please visit our website to view the most current information.
 © 2023 LOS ANGELES LIGHTING MANUFACTURING CO. ALL RIGHTS RESERVED. Revised: 04/11/2023

