



RECESSED FDH440



4' x 4' REGRESSED LENS FLANGED LUMINAIRE

JOB	
TYPE	
DATE	

Commercial / Office



Overall dimensions including flange: 50" x 50"
Required ceiling opening: 48 1/2" x 48 1/2"

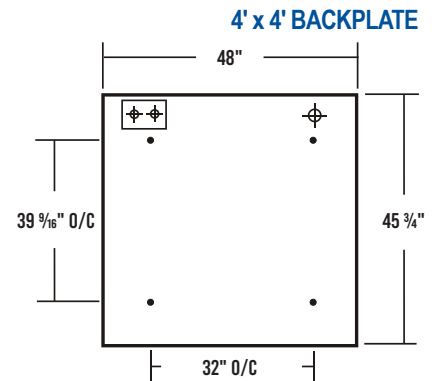
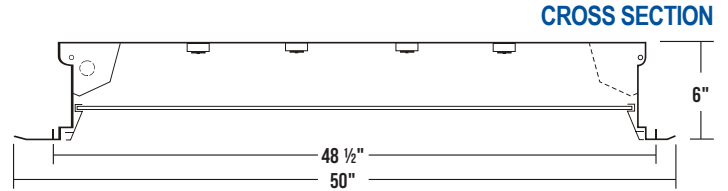

- Access Plate
- 7/8" KO
- 3/8" KO

SPECIFICATIONS

Construction

- 22 gauge cold-rolled steel housing
- 2" deep regressed extruded aluminum door frame, secured by T-hinge and spring-loaded latches
- One way polyurethane gasket
- 2 gussets installed in each corner for maximum strength and true miter alignment

Finish

- Baked white polyester finish
- Minimum reflectance 86%
- Door frame and trim flange painted after fabrication

Optical

- One-piece clear prismatic acrylic lens
- Other lens options may require center mullion

Electrical

- High-efficiency drivers coupled with long-life LEDs
- Service life greater than 50,000 hours (L70)
- Universal voltage 120V through 277V (347V / 480V available)
- Power Factor (PF) ≥ 0.9
- Total Harmonic Distortion (THD) ≤ 20%

Listing

- UL USA and Canada listed / suitable for wet location

Warranty

- 5-Year limited warranty standard. 10-Year limited warranty also available

APPLICATIONS

- Commercial, Office

FEATURES

- 0-10V dimming driver standard
- Supports California Title 24 compliance
- Suitable for damp locations

OPTIONS

- Sensors and controls
- Range of lumen packages and color temperatures
- Various lenses
- 20 gauge housing
- Painted after fabrication
- Tunable white (2700K – 6500K)
- Emergency battery pack
- Swing-out jacks
- Hanger yokes
- Customization available upon request



Los Angeles Lighting Mfg. Co.
 Contact Us
 T: 626-454-8300 10141 Olney Street
 F: 626-454-8399 El Monte, CA 91731
 www.lalighting.com Made in the USA



Due to continued product improvements and enhancements, Los Angeles Lighting Manufacturing Company reserves the right to alter specifications, dimensions, data, and/or materials without notice. Please visit our website to view the most current information.

© 2024 LOS ANGELES LIGHTING MANUFACTURING CO. ALL RIGHTS RESERVED

Revised: 10/25/24



ORDERING INFORMATION: Additional Options Available. Visit www.lalighting.com/resources for more information

EXAMPLE: FDH440-16-4L-R2W-PA8(1PC)-DRDM-UNV-4/840									
SERIES	NOMINAL LED LUMENS	NOMINAL LENGTH	DOOR FRAME	OPTICAL	ELECTRICAL	DRIVER	VOLTAGE	# OF LED ROWS	CRI / CCT
FDH440		4L						4	
FDH440 • 4' x 4' Regressed Lens Flanged Luminaire	4 - 4000 lm 8 - 8000 lm 12 - 12000 lm 16 - 16000 lm 20 - 20000 lm 24 - 24000 lm High Efficacy 8HE - 8000 lm 12HE - 12000 lm 16HE - 16000 lm 20HE - 20000 lm 24HE - 24000 lm	4L • 4'	R2W • White Enamel R2B • Black Enamel R2N • Natural Anodized Aluminum	FFWA2(1PC) • One-Piece Flat Frosted White Acrylic FFWA • Two-Piece Flat Frosted White Acrylic PA8(1PC) • One-Piece Clear Prismatic Acrylic PA • Two-Piece Clear Prismatic Acrylic	BPL1.5 • 1500 lm emergency battery pack WLC(xx) • Wireless Control *Leave blank if not specified	DRDM • 0-10V Dimming Driver	UNV • 120V-277V 120V • 120 Volt 277V • 277 Volt 347V • 347 Volt 480V • 480 Volt	4 • Four LED Rows	827 • 80+CRI / 2700K 830 • 80+CRI / 3000K 835 • 80+CRI / 3500K 840 • 80+CRI / 4000K 850 • 80+CRI / 5000K 865 • 80+CRI / 6500K 8TW • 80+CRI Tunable White 2700K-6500K 90CRI Also available
Standard options for FDH440 shown above. For additional options, including lumen packages, controls, lenses, switches, finishes, and more, visit www.lalighting.com/resources or contact customer service.									Contact customer service for additional CRI/CCT packages.

DOOR FRAME

CROSS SECTION

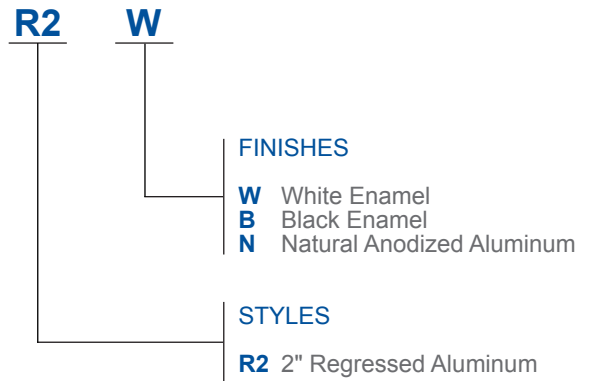
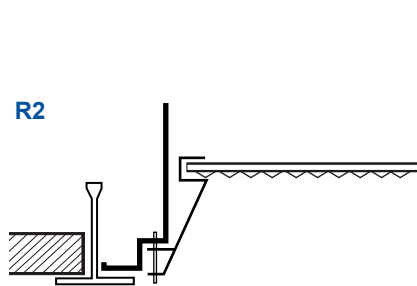

OPTICAL OPTIONS

STANDARD LENSES FOR FDH440 - Contact Customer Service for lead times. Two-piece lenses require a center mullion.

- CA2(1PC)** One-Piece Clear Acrylic, Nom. 0.125" OA Thickness
- FFA2(1PC)** One-Piece Flat Frosted Acrylic, Nom. 0.125" Thickness
- FFWA2(1PC)** One-Piece Flat Frosted White Acrylic, Nom. 0.125" Thickness
- PA8(1PC)** One-Piece Clear Prismatic Acrylic, Nom. 0.187" OA Thickness, Female Prisms 3/16" Square Base, Pattern 12
- FFWA** Two-Piece Flat Frosted White Acrylic, No Thickness Specified
- FPA2** Two-Piece Frosted Prismatic Acrylic, Nom. 0.125" OA Thickness, Female Prisms 3/16" Square Base, Pattern 12
- PA** Two-Piece Clear Prismatic Acrylic, No Thickness Specified, Female Prisms 3/16" Square Base, Pattern 12



Two-piece lens with center mullion



Los Angeles Lighting Mfg. Co.
 Contact Us
 T: 626-454-8300 10141 Olney Street
 F: 626-454-8399 El Monte, CA 91731
www.lalighting.com Made in the USA



Due to continued product improvements and enhancements, Los Angeles Lighting Manufacturing Company reserves the right to alter specifications, dimensions, data, and/or materials without notice. Please visit our website to view the most current information.

© 2024 LOS ANGELES LIGHTING MANUFACTURING CO. ALL RIGHTS RESERVED

Revised: 10/25/24



MOUNTING HARDWARE

HANGER YOKES

HS-48_1/2

- Used to secure recessed flanged fixtures to support frame in hard ceilings
- Provided screws secure hanger yoke to fixture through knockouts in top of housing
- Two hanger yokes required for each 2' or 4' luminaire.

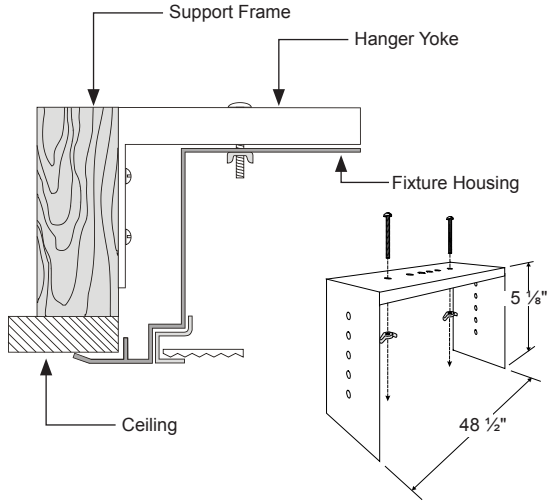

SWING-OUT JACKS

SOJ

- Spring-loaded adjustable mounting brackets used to secure recessed flanged fixtures to support frame in hard ceilings
- Four swing-out jacks per set; 1 set required per fixture

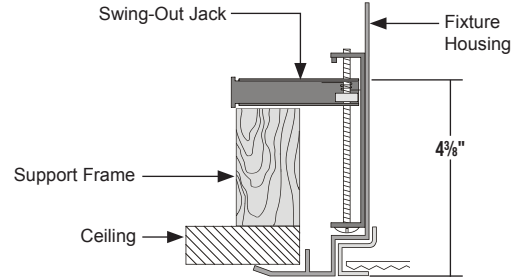

SYSTEM DATA: Additional Lumen Packages Available. Contact Customer Service for More Information

4' Normal Temp	4' - LED LUMEN PACKAGE	PRODUCT CODE	DELIVERED LUMENS	SYSTEM WATTS	LUMINAIRE EFFICACY	AMBIENT TEMP.	FLUORESCENT EQUIVALENT	IES FILES
	4000 Lumens (Nominal)	FDH440-4-4L-R2W-PA-DRDM-UNV-4/840	3376	25.4	132.8 lm/W	-20°C / 35°C (-4°F / 95°F)	1x F54T5HO 2x F32T8	*
	8000 Lumens (Nominal)	FDH440-8-4L-R2W-PA-DRDM-UNV-4/840	6745	50.1	134.7 lm/W	-20°C / 35°C (-4°F / 95°F)	3x F32T8	*
	12000 Lumens (Nominal)	FDH440-12-4L-R2W-PA-DRDM-UNV-4/840	10035	75.6	132.8 lm/W	-20°C / 35°C (-4°F / 95°F)	5x F32T8	*
	16000 Lumens (Nominal)	FDH440-16-4L-R2W-PA-DRDM-UNV-4/840	13245	102.4	129.4 lm/W	-20°C / 35°C (-4°F / 95°F)	3x F54T5HO 6x F32T8	LA-T3727-1
	20000 Lumens (Nominal)	FDH440-20-4L-R2W-PA-DRDM-UNV-4/840	16375	129.9	126.0 lm/W	-20°C / 35°C (-4°F / 95°F)	4x F54T5HO	*
	24000 Lumens (Nominal)	FDH440-24-4L-R2W-PA-DRDM-UNV-4/840	19727	160.9	122.6 lm/W	-20°C / 35°C (-4°F / 95°F)	6x F54T5HO	*

4' Normal Temp High Efficacy	4' - LED LUMEN PACKAGE	PRODUCT CODE	DELIVERED LUMENS	SYSTEM WATTS	LUMINAIRE EFFICACY	AMBIENT TEMP.	FLUORESCENT EQUIVALENT	IES FILES
	8000 Lumens (Nominal)	FDH440-8HE-4L-R2W-PA-DRDM-UNV-4/840	6562	44.8	146.5 lm/W	-20°C / 35°C (-4°F / 95°F)	3x F32T8	*
	12000 Lumens (Nominal)	FDH440-12HE-4L-R2W-PA-DRDM-UNV-4/840	9816	66.6	147.3 lm/W	-20°C / 35°C (-4°F / 95°F)	5x F32T8	*
	16000 Lumens (Nominal)	FDH440-16HE-4L-R2W-PA-DRDM-UNV-4/840	12965	89.6	144.8 lm/W	-20°C / 35°C (-4°F / 95°F)	3x F54T5HO 6x F32T8	*
	20000 Lumens (Nominal)	FDH440-20HE-4L-R2W-PA-DRDM-UNV-4/840	16341	115.8	141.1 lm/W	-20°C / 35°C (-4°F / 95°F)	4x F54T5HO	*
	24000 Lumens (Nominal)	FDH440-24HE-4L-R2W-PA-DRDM-UNV-4/840	19586	141.5	138.5 lm/W	-20°C / 35°C (-4°F / 95°F)	6x F54T5HO	*

NOTE:
System data as of 4/26/24.
Subject to change without notice.

System data is based on 120V input voltage. Actual performance may differ as a result of end-user environment and application. This fixture has been tested and listed in accordance with UL Standards. L.A. Lighting certifies that it will operate safely when installed properly, and within an ambient temperature range noted in the system data table.

Additional lumen packages and color temperatures available.



Los Angeles Lighting Mfg. Co.
 Contact Us
 T: 626-454-8300 10141 Olney Street
 F: 626-454-8399 El Monte, CA 91731
 www.lalighting.com Made in the USA



Due to continued product improvements and enhancements, Los Angeles Lighting Manufacturing Company reserves the right to alter specifications, dimensions, data, and/or materials without notice. Please visit our website to view the most current information.

© 2024 LOS ANGELES LIGHTING MANUFACTURING CO. ALL RIGHTS RESERVED

Revised: 10/25/24



PHOTOMETRIC DATA

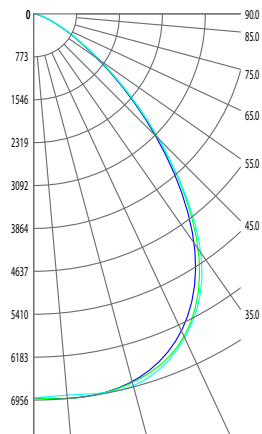

FDH440-16-4L-R2W-PA-DRDM-UNV-4/840

TEST NO. = LA-T3727-1
 LED ROWS = 4
 SYSTEM WATTS (W) = 102.4
 CRI ≥ 80
 L70(Hrs.) ≥ 50,000
 PHOTOMETRY TYPE = C

ZONAL LUMEN SUMMARY			
DEGREES	LUMENS	% LAMP	% FIXTURE
0-30	5571	34	42
0-40	8809	54	67
0-60	12550	77	95
0-90	13245	81	100.0
90-120	0	0	0
90-150	0	0	0
90-180	0	0	0
0-180	13245	81	100.0

SPACING CRITERION	
ALONG	ACROSS
1.20	1.24

Luminaire Output = 13245 lumens
 Luminaire Efficacy = 129.4 lm/W
 Luminaire Efficiency = 81.03%

0.0
 45.0
 90.0



Los Angeles Lighting Mfg. Co.
 Contact Us
 T: 626-454-8300 10141 Olney Street
 F: 626-454-8399 El Monte, CA 91731
 www.lalighting.com Made in the USA



Due to continued product improvements and enhancements, Los Angeles Lighting Manufacturing Company reserves the right to alter specifications, dimensions, data, and/or materials without notice. Please visit our website to view the most current information.

© 2024 LOS ANGELES LIGHTING MANUFACTURING CO. ALL RIGHTS RESERVED Revised: 10/25/24

