



# SURFACE MOUNT

## MHL306

6" WIDE HINGE AND LATCH TROFFER



JOB	
TYPE	
DATE	

### Surface-Mounted



#### CROSS SECTION

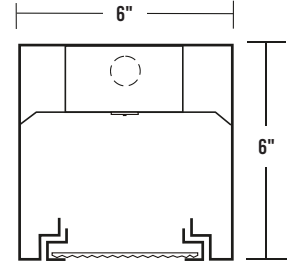

#### 4' BACKPLATE

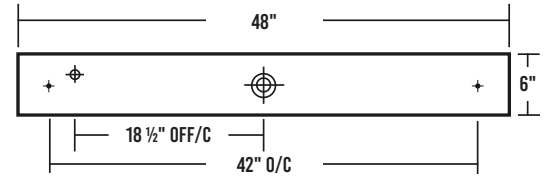

#### 8' BACKPLATE

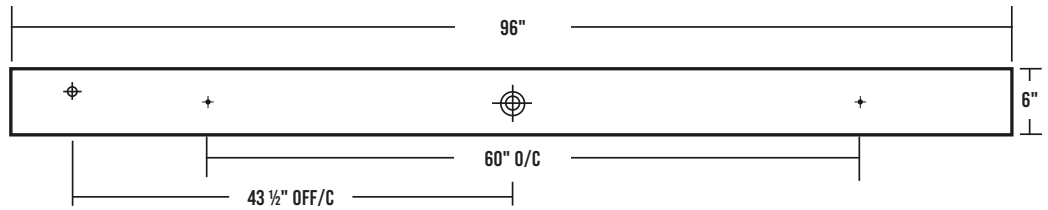

- 2" K.O.
- 7/8" OFFSET K.O.
- 11/16" MOUNTING K.O.

## SPECIFICATIONS

### Construction

- 22 gauge cold-rolled steel housing
- 20 gauge cold-rolled steel door frame secured by T-hinges and positive spring loaded latches
- One-way polyurethane gasket

### Finish

- Baked white powder-coated finish
- Painted after fabrication
- Minimum reflectance 90%

### Optical

- Clear prismatic acrylic lens

### Electrical

- High-efficiency drivers coupled with long-life LEDs
- Service life tested at 148,000 hours (L70)
- Universal voltage 120V through 277V (347V / 480V available)
- Power Factor (PF)  $\geq 0.9$
- Total Harmonic Distortion (THD)  $\leq 20\%$

### Listing

- UL USA and Canada listed / suitable for damp locations

### Warranty

- 5-Year limited warranty standard. 10-Year limited warranty also available

## APPLICATIONS

- Offices, Schools, Commercial

## FEATURES

- 0-10V dimming driver standard
- Supports California Title 24 compliance

## OPTIONS

- Range of lumen packages and color temperatures
- Sensors and controls
- Lens options
- Tunable white (2700K – 6500K)
- Emergency battery pack
- Extruded aluminum door frame
- Neoprene gasket
- Customization available upon request



**Los Angeles Lighting Mfg. Co.**  
 Contact Us  
 T: 626-454-8300 10141 Olney Street  
 F: 626-454-8399 El Monte, CA 91731  
 www.lalighting.com Made in the USA



Due to continued product improvements and enhancements, Los Angeles Lighting Manufacturing Company reserves the right to alter specifications, dimensions, data, and/or materials without notice. Please visit our website to view the most current information.

© 2024 LOS ANGELES LIGHTING MANUFACTURING CO. ALL RIGHTS RESERVED

Revised: 11/04/24



ORDERING INFORMATION: Additional Options Available. Visit [www.lalighting.com/resources](http://www.lalighting.com/resources) for more information

EXAMPLE: MHL306-4-4L-FSW-PA-BPL1.5-DRDM-UNV-1/840										
SERIES	NOMINAL LED LUMENS	NOMINAL LENGTH	DOOR FRAME	OPTICAL	MECHANICAL	ELECTRICAL	DRIVER	VOLTAGE	# OF LED ROWS	CRI / CCT
MHL306									1	
<b>MHL306</b> • 6" Wide Hinge and Latch Troffer	2 - 2000 lm 4 - 4000 lm 6 - 6000 lm 8 - 8000 lm  High Efficacy 2HE - 2000 lm 4HE - 4000 lm 6HE - 6000 lm 8HE - 8000 lm	4L • 4'	<b>FSW</b> • Flat Steel White Enamel	<b>PA</b> • Clear Prismatic Acrylic  <b>PA2</b> • Clear Prismatic Acrylic 0.125"  <b>FPA2</b> • Frosted Prismatic Acrylic 0.125"  <b>FFWA</b> • Flat Frosted White Acrylic	<b>GSKNx</b> • Neoprene Gasket  *Leave blank for standard 1-way polyurethane gasket	<b>BPL1.5</b> • 1500 lm emergency battery pack  <b>WLC(xx)</b> • Wireless Control  *Leave blank if not specified	<b>DRDM</b> • 0-10V Dimming Driver	<b>UNV</b> • 120V-277V	1 • One LED Row	<b>827</b> • 80+CRI / 2700K  <b>830</b> • 80+CRI / 3000K  <b>835</b> • 80+CRI / 3500K  <b>840</b> • 80+CRI / 4000K  <b>850</b> • 80+CRI / 5000K  <b>865</b> • 80+CRI / 6500K  <b>8TW</b> • 80+CRI Tunable White 2700K-6500K  90CRI Also available
	4 - 4000 lm 8 - 8000 lm 12 - 12000 lm 16 - 16000 lm  High Efficacy 4HE - 4000 lm 8HE - 8000 lm 12HE - 12000 lm 16HE - 16000 lm	8L • 8'		Standard options for MHL306 shown above. For additional options, including lumen packages, controls, lenses, switches, finishes, and more, visit <a href="http://www.lalighting.com/resources">www.lalighting.com/resources</a> or contact customer service.						

DOOR FRAME CROSS SECTION

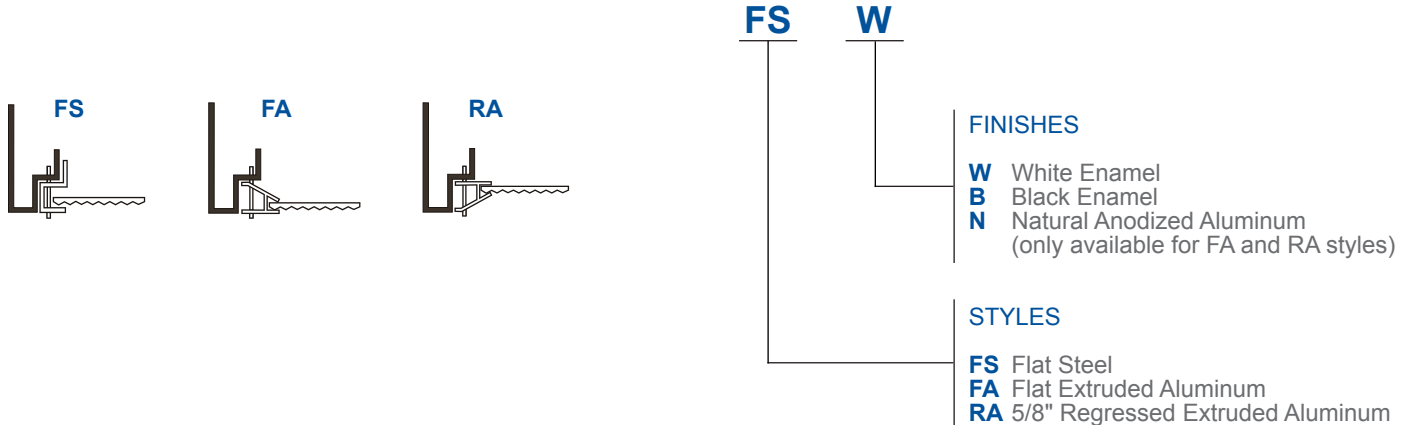

OPTICAL OPTIONS

STANDARD LENSES FOR MHL306

- PA** Clear Prismatic Acrylic, No Thickness Specified, Female Prisms 3/16 Square Base
- PA2** Clear Prismatic Acrylic, Nom. 0.125" OA Thickness, Female Prisms 3/16 Square Base
- FFWA** Flat Frosted White Acrylic
- FPA2** Frosted Prismatic Acrylic, Nom. 0.125" OA Thickness, Female Prisms 3/16 Square Base



Los Angeles Lighting Mfg. Co.  
 Contact Us  
 T: 626-454-8300 10141 Olney Street  
 F: 626-454-8399 El Monte, CA 91731  
[www.lalighting.com](http://www.lalighting.com) Made in the USA



Due to continued product improvements and enhancements, Los Angeles Lighting Manufacturing Company reserves the right to alter specifications, dimensions, data, and/or materials without notice. Please visit our website to view the most current information.

© 2024 LOS ANGELES LIGHTING MANUFACTURING CO. ALL RIGHTS RESERVED

Revised: 11/04/24



## NEOPRENE GASKET

If Neoprene gasketing is not specified, standard 1-way polyurethane gasket will be used.

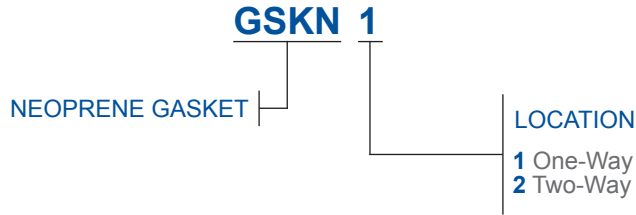

### 1-WAY

Gasket between housing and door frame. Only for FS and FA style door frames.

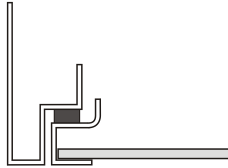

### 2-WAY

Additional gasket between door frame and lens. Only for FS style door frames.

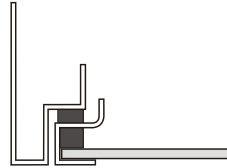

## MOUNTING HARDWARE

### CANOPY / CABLE SUSPENSION SYSTEMS

Self-locking, one-step adjustable suspension devices with canopy



#### 433B

- Canopy with cable
- No power cord
- Cable length 48" and 96"
- Max. Weight 196 lbs.

#### 433B-48 W

##### COLOR

- W - White
- B - Black

##### CABLE LENGTH

- 48 - 48 inches
- 96 - 96 inches
- (other lengths as specified)



#### 444F

- Feed-in canopy with straight cord
- Includes power cord
- Cable length 48" and 96"
- Max. Weight 196 lbs

#### 444F-48W-2C

##### # OF CIRCUITS

- 2C - Two circuits
- LV - 0-10V dimming
- Blank - One circuit

##### COLOR

- W - White
- B - Black

##### CABLE LENGTH

- 48 - 48 inches
- 96 - 96 inches
- (other lengths as specified)



**Los Angeles Lighting Mfg. Co.**  
 Contact Us  
 T: 626-454-8300 10141 Olney Street  
 F: 626-454-8399 El Monte, CA 91731  
 www.lalighting.com Made in the USA



Due to continued product improvements and enhancements, Los Angeles Lighting Manufacturing Company reserves the right to alter specifications, dimensions, data, and/or materials without notice. Please visit our website to view the most current information.

© 2024 LOS ANGELES LIGHTING MANUFACTURING CO. ALL RIGHTS RESERVED

Revised: 11/04/24



## MOUNTING HARDWARE

### THREADED MOUNTING STEMS

#### STEM

- 3/8" IPS, nominal OD 5/8"
  - Threaded 1" each end
  - 2 lock nuts provided per stem
  - Standard lengths: 6", 12", 18", 24", 30", 36", 48"
  - Baked white enamel finish
  - To order, specify length required after STEM.
- Example: **STEM12** for 12", **STEM24** for 24", etc.

Other lengths & finishes are available as specified

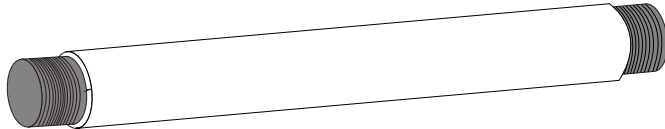

#### Stem Length Calculation

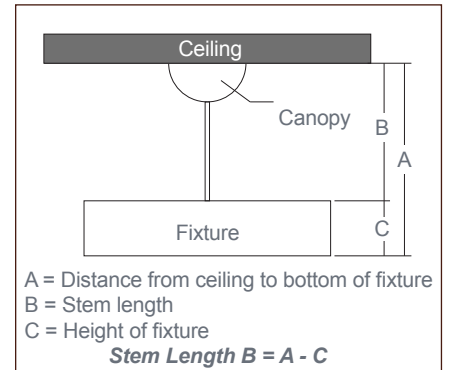

### SYSTEM DATA: Additional Lumen Packages Available. Contact Customer Service for More Information

Normal Temp	4'	LED LUMEN PACKAGE	NORMAL AMBIENT TEMPERATURE PRODUCT CODE	DELIVERED LUMENS	SYSTEM WATTS	LUMINAIRE EFFICACY	AMBIENT TEMP.	FLUORESCENT EQUIVALENT	IES FILES
		2000 Lumens (Nominal)	MHL306-2-4L-FSW-PA-DRDM-UNV-1/840	1013	12.5	81.3 lm/W	-20°C / 35°C (-4°F / 95°F)	1x F32T8	*
		4000 Lumens (Nominal)	MHL306-4-4L-FSW-PA-DRDM-UNV-1/840	1989	25.5	77.9 lm/W	-20°C / 35°C (-4°F / 95°F)	1x F54T5HO 2x F32T8	*
		6000 Lumens (Nominal)	MHL306-6-4L-FSW-PA-DRDM-UNV-1/840	2936	39.1	75.2 lm/W	-20°C / 35°C (-4°F / 95°F)	3x F32T8	*
		8000 Lumens (Nominal)	MHL306-8-4L-FSW-PA-DRDM-UNV-1/840	3856	53.1	72.7 lm/W	-20°C / 35°C (-4°F / 95°F)	2x F54T5HO 4x F32T8	*

Normal Temp High Efficacy	4'	LED LUMEN PACKAGE	NORMAL AMBIENT TEMPERATURE (HIGH EFFICACY) PRODUCT CODE	DELIVERED LUMENS	SYSTEM WATTS	LUMINAIRE EFFICACY	AMBIENT TEMP.	FLUORESCENT EQUIVALENT	IES FILES
		2000 Lumens (Nominal)	MHL306-2HE-4L-FSW-PA-DRDM-UNV-1/840	1030	12.4	83.4 lm/W	-20°C / 35°C (-4°F / 95°F)	1x F32T8	*
		4000 Lumens (Nominal)	MHL306-4HE-4L-FSW-PA-DRDM-UNV-1/840	2027	24.9	81.3 lm/W	-20°C / 35°C (-4°F / 95°F)	1x F54T5HO 2x F32T8	*
		6000 Lumens (Nominal)	MHL306-6HE-4L-FSW-PA-DRDM-UNV-1/840	3009	37.8	79.7 lm/W	-20°C / 35°C (-4°F / 95°F)	3x F32T8	*
		8000 Lumens (Nominal)	MHL306-8HE-4L-FSW-PA-DRDM-UNV-1/840	3978	50.9	78.1 lm/W	-20°C / 35°C (-4°F / 95°F)	1x F54T5HO 2x F32T8	*



**Los Angeles Lighting Mfg. Co.**  
 Contact Us  
 T: 626-454-8300 10141 Olney Street  
 F: 626-454-8399 El Monte, CA 91731  
 www.lalighting.com Made in the USA



Due to continued product improvements and enhancements, Los Angeles Lighting Manufacturing Company reserves the right to alter specifications, dimensions, data, and/or materials without notice. Please visit our website to view the most current information.

© 2024 LOS ANGELES LIGHTING MANUFACTURING CO. ALL RIGHTS RESERVED

Revised: 11/04/24



SYSTEM DATA: Additional Lumen Packages Available. Contact Customer Service for More Information

Normal Temp	8'	LED LUMEN PACKAGE	NORMAL AMBIENT TEMPERATURE PRODUCT CODE	DELIVERED LUMENS	SYSTEM WATTS	LUMINAIRE EFFICACY	AMBIENT TEMP.	FLUORESCENT EQUIVALENT	IES FILES
		4000 Lumens (Nominal)	MHL306-4-4L-FSW-PA-DRDM-UNV-1/840	2027	24.9	81.3 lm/W	-20°C / 35°C (-4°F / 95°F)	2x F32T8	*
		8000 Lumens (Nominal)	MHL306-8-4L-FSW-PA-DRDM-UNV-1/840	3978	50.9	78.1 lm/W	-20°C / 35°C (-4°F / 95°F)	2x F54T5HO 4x F32T8	*
		12000 Lumens (Nominal)	MHL306-12-4L-FSW-PA-DRDM-UNV-1/840	5873	78.0	75.3 lm/W	-20°C / 35°C (-4°F / 95°F)	6x F32T8 2x F96T8HO	*
		16000 Lumens (Nominal)	MHL306-16-4L-FSW-PA-DRDM-UNV-1/840	7711	106.1	72.7 lm/W	-20°C / 35°C (-4°F / 95°F)	4x F54T5HO 8x F32T8	*

Normal High Efficacy	8'	LED LUMEN PACKAGE	NORMAL AMBIENT TEMPERATURE (HIGH EFFICACY) PRODUCT CODE	DELIVERED LUMENS	SYSTEM WATTS	LUMINAIRE EFFICACY	AMBIENT TEMP.	FLUORESCENT EQUIVALENT	IES FILES
		4000 Lumens (Nominal)	MHL306-4HE-4L-FSW-PA-DRDM-UNV-1/840	2059	24.6	83.8 lm/W	-20°C / 35°C (-4°F / 95°F)	2x F32T8	*
		8000 Lumens (Nominal)	MHL306-8HE-4L-FSW-PA-DRDM-UNV-1/840	3855	47.2	81.7 lm/W	-20°C / 35°C (-4°F / 95°F)	2x F54T5HO 4x F32T8	*
		12000 Lumens (Nominal)	MHL306-12HE-4L-FSW-PA-DRDM-UNV-1/840	5823	72.8	80.0 lm/W	-20°C / 35°C (-4°F / 95°F)	6x F32T8 2x F96T8HO	*
		16000 Lumens (Nominal)	MHL306-16HE-4L-FSW-PA-DRDM-UNV-1/840	7763	99.1	78.4 lm/W	-20°C / 35°C (-4°F / 95°F)	2x F54T5HO 4x F32T8	*

**NOTE:**  
System data as of 10/15/24 (K-Boards).  
Luminaire efficiency: 47.5%  
Subject to change without notice.

System data is based on 120V input voltage. Actual performance may differ as a result of end-user environment and application. This fixture has been tested and listed in accordance with UL Standards. L.A. Lighting certifies that it will operate safely when installed properly, and within an ambient temperature range noted in the system data table.

Additional lumen packages and color temperatures available.



**Los Angeles Lighting Mfg. Co.**  
Contact Us  
T: 626-454-8300 10141 Olney Street  
F: 626-454-8399 El Monte, CA 91731  
www.lalighting.com Made in the USA



Due to continued product improvements and enhancements, Los Angeles Lighting Manufacturing Company reserves the right to alter specifications, dimensions, data, and/or materials without notice. Please visit our website to view the most current information.

© 2024 LOS ANGELES LIGHTING MANUFACTURING CO. ALL RIGHTS RESERVED

Revised: 11/04/24

